



LUXURY  
HAS A NEW ADDRESS AT  
**THIRUVALLA**



(The First Integrated Township in Central Travancore)



K RERA/PRJ/ KTM/065/2021

[www.pushpagiriyilbuilders.com](http://www.pushpagiriyilbuilders.com)

LOVE  
BUILDS A  
HAPPY HOME...





It is the time to compliment your success with an improved lifestyle at par with International Standard. Pushpagiriyil Builders & Developers is launching **Santos City**, the first integrated Township at Thiruvalla. Spreading over 4.3 Acres, sprawling green, high-end inspire living amidst landscaping and secured family environment. Conveniently located close to the city yet far from the madding crowd and the cacophony of city traffic. **Santos City** offers several residential options depending upon individual family requirements and budget. Villas and flats are designated with Classical & Contemporary concept with the option of 2 BHK, 3 BHK & 4 BHK as per your needs and budget. **Santos City** offers all basic amenities and premium landscaping to every villa and flat to give a luxury feel to live in.



puslapangit  
SANTOS CITY  
GATED COMMUNITY

GATE WAY  
TO YOUR  
DREAMS...



# AMPHITHEATRE

pushpagirrigil  
BUILDERS & DEVELOPERS

A detailed rendering of a children's park. In the background, a modern two-story building with white and dark grey panels and large windows stands behind a line of trees. The park itself is lush with green grass, various trees including palm trees, and flowering bushes with pink and red blossoms. In the center, there is a swing set with red frames and yellow seats. To the right, a large play structure with a red canopy, yellow slides, and green safety railings is situated on a sandpit. The foreground features a paved area with grey and white tiles and a set of stone steps leading up to the play area. Two wooden benches are visible on the right side of the park.

## CHILDREN'S PARK

# CLUB HOUSE

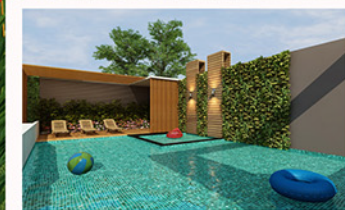

Swimming Pool



Multipurpose Hall



Gymnasium

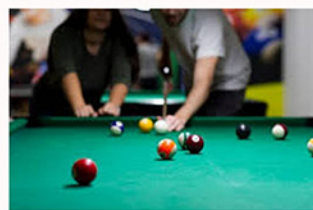

Indoor Game



Grocery



Spa

# BADMINTON COURT





ELDER'S PARK



BUSINESS LOUNGE

# SWIMMING POOL





YOGA PARK

# GYMNASIUM

A modern gym interior with a wooden floor and a large window overlooking a city. The gym is equipped with several treadmills, weight machines, and free weights. A man is running on one of the treadmills. The word "GYMNASIUM" is overlaid on the left side of the image.

# MULTIPURPOSE HALL





## INDOOR GAMES



LIVING



# BED ROOM





KITCHEN

DINING





## Area Details

### 3 BHK

PLOT NO.	LAND AREA	AREA
15,16, 20, 28B, 30A, 30B, 33, 35A	3.5 Cents	1450 Sqft.
15,16, 20, 28B, 30A, 30B, 33, 35A	3.80 Cents	1550 Sqft.
8, 12A, 17, 18, 19, 21, 22, 24, 25, 28A, 29, 34, 35B, 44	4 Cents	1600 Sqft.
32	4.17 Cents	1700 Sqft.
31	4.29 Cents	1750 Sqft.
42	4.50 Cents	1850 Sqft.
3, 5, 9, 14, 23, 37, 45	4.59 Cents	1850 Sqft.
46	4.75 Cents	1950 Sqft.
48	4.89 Cents	2000 Sqft.

### 4 BHK

PLOT NO.	LAND AREA	AREA
26, 36, 38, 39, 41, 49, 50	5 Cents	2100 Sqft.
2, 4, 12B	5.50 Cents	2250 Sqft.
7	5.64 Cents	2250 Sqft.
27	6 Cents	2400 Sqft.
40	6.30 Cents	2500 Sqft.
1	7 Cents	2700 Sqft.
47	7.67 Cents	2900 Sqft.

## LOCATION MAP

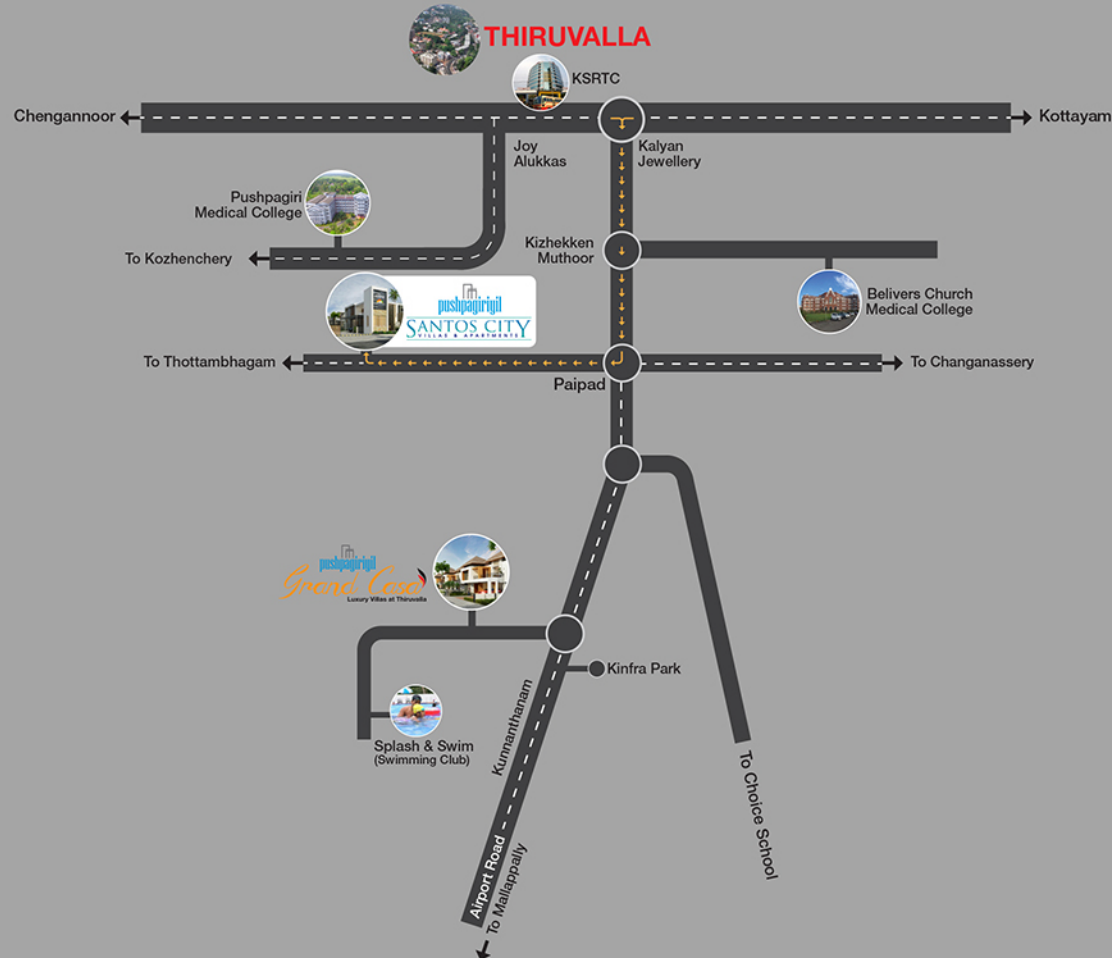

## DISTANCE AT A GLANCE

Belivers Church Medical College	2.5 km
Pushpagiri Medical College	6 km
Medical Mission Hospital	4.5 km
Belivers Church Residential School	2.5 km
Marthoma Residential School	3.5 km
Choice School	5.5 km
Chirst Central School	6 km
Amrutha School	8 km
St. Marys Residential School	7.5 km
MACFAST	9 km
Govt. Engineering College	8 km
Marthoma College	4.5 km
SB College	8.5 km
Railway Station	5 km
KSRTC Station	6 km
Kinfra Park	2 km
Mallappally	10.5 km
Changanassery	8 km
Proposed Air Port	36 km





## **BUILDERS & DEVELOPERS**

Head Office : Edamon, Punalur, Kollam(District)  
Site Office : Anjilithanam, THIRUVALLA  
Phone : +91-7594883709, +91-8848505016  
: Kuwait - 0096596098657  
E-mail : [info@pushpagiriyilbuilders.com](mailto:info@pushpagiriyilbuilders.com)  
Website : [www.pushpagiriyilbuilders.com](http://www.pushpagiriyilbuilders.com)

